

PLUGS 0470 AND 0044

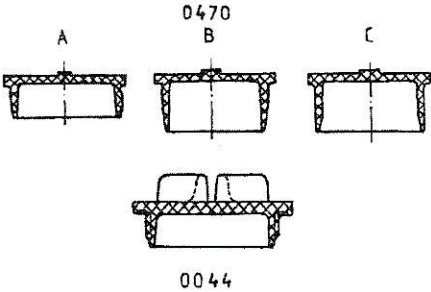

Plugs 0470 and 0044, shown in the figure above, are employed to protect male and female threads, internal and external surface areas from damage and dirt in transportation, during assembly, disassembly, surface treatment (protection) and painting.

Unthreaded plugs 0470 are manufactured in three variants. Variant A is employed with unthreaded ports, variant B is employed with threaded ports, and variant C is employed with male threads.

Threaded plugs 0044 are employed with threaded ports: metric thread (M), pipe thread (G) and UNF thread.

Material

Standard range plugs 0470 are manufactured from polyethylene, hardness 70±5 Shore - A, natural color.

Standard range plugs 0044 are manufactured from polyethylene, hardness 65.5 Shore - D, black for metric threads, white for pipe threads, and red for UNF threads.

PLUGS 0470

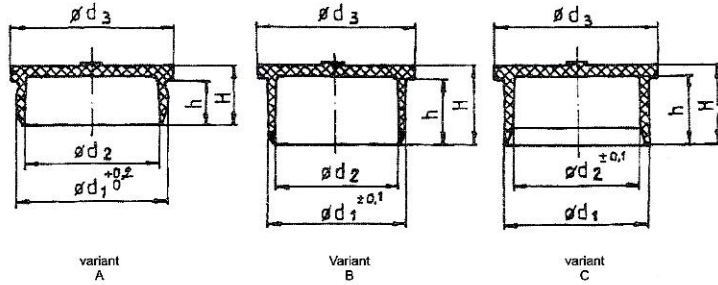

Table 1

Normal size	variant A	Plugs Variant B	variant C	d1	d2	d3	h	H
43	4			4,2	2,7	6,5	4,5	6
53	5			5,2	3,5	7,5	4,5	6
63	6			6,2	4	9	4,5	6
73		M8 x 1		7,2	5,5	13	5,3	8
83	8			8,3	6	11	4,5	6
93		M10 x 1		9,3	7,5	14	6,3	9
93C			M8 x 1	9,5	7,7	12	9	10
105	10			10,5	7,5	14	6	8
109		M12 x 1,5		10,9	8,5	17	8,3	11
114			M10 x 1	11,5	9,7	14	10	11
124	12			12,6	9	16	6	8
128		M14 x 1,5		12,9	10,5	19	9,3	12
133			M12 x 1,5	13,5	11,7	16	11	12,5
143	14			14,5	11	18	7,5	10
149		M16 x 1,5		14,9	12,5	21	9,3	12
153			M14 x 1,5	15,5	13,6	18	11	12,5
164	16			16,6	13	20	7,5	10
169		M18 x 1,5		16,9	14,5	23	9,3	12
173			M16 x 1,5	17,5	15,5	20	12	14
188	18			18,8	15	23	7,5	10
188B		M20 x 1,5		18,9	16,5	25	10,3	13
193			M18 x 1,5	19,5	17,5	22	13	15
205	20			20,8	17	25	7,5	10

PLUGS 0470

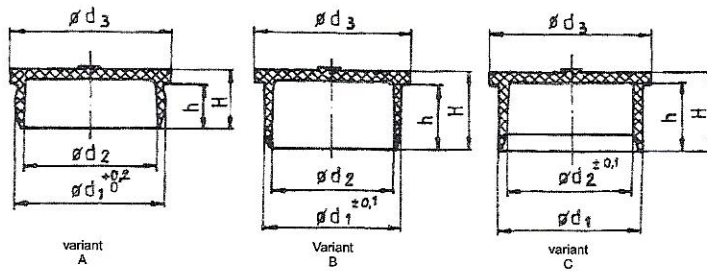

Table 1.

Normal size	Variant A	Plugs Variant B	Variant C	d1	d2	d3	h	H
208		M22 x 1,5		20,9	18,5	27	11	14
208C			M20 x 1,5	21,5	19,5	25	14	16
232		M24 x 1,5		22,9	20,5	29	11	14
232C			M22 x 1,5	23,5	21,4	27	16	18
248		M26 x 1,5		24,9	21,5	31	12	15
255	25			26	21,5	30	10	13
255B		M27 x 2		25,5	23	32	12	15
255C			M24 x 1,5	25,5	23,4	29	16	18
259		M27 x 1,5		25,9	22,5	33	13	16
272			M26 x 1,5	27,5	25,3	31	18	20
284		M30 x 2		28,5	26	35	13	16
284C			M27 x 1,5 M30 x 2	28,5	26,3	32	18	20,5
308	30			31,2	26,5	34	10	13
317		M33 x 2		31,5	29	39	14,5	18
317C			M30 x 1,5 M30 x 2	31,5	29,3	35	19	22
328	32			33,2	28,5	36	10	13
346		M36 x 2		34,5	32	42	14,5	18
346C			M33 x 2	34,5	32,2	38	19	22
368		M38 x 1,5		36,9	33,5	44	14,5	18
375		M39 x 2		37,5	35	45	14,5	18
375C			M36 x 2	37,5	35,2	42	21	24
388	38			39,2	34,5	44	11,5	15
406	40			41,2	36,5	46	11,5	15
406B		M42 x 2		40,5	38	48	14,5	18
406C			M39 x 2	40,5	38,2	45	21	24
435		M45 x 2		43,5	41	51	14,5	18
435C			M42 x 2	43,2	41,2	48	21	24
468		M48 x 2		46,5	43	55	15,5	19
508	50			51,5	46,5	56	12	16
508B		M52 x 2		50,5	47	59	16,5	20
508C			M48 x 2	50	47	55	23	26
548		M56 x 2		54,5	51	63	17,5	21
548C			M52 x 2	54	51	59	26	29
610	60			61,5	55	66	13,5	18
1275	125			127,5	118	135	24	32

Order example: Plug for threaded port M 24 x 1,5 nominal size 255C
Plug 0470 255 C

PLUGS 0044

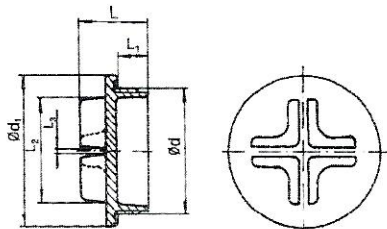
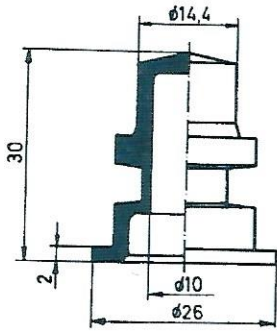

Table 2

Nominal size	Ød1	L ₁	L ₂	L ₄	L
M5 X 0,8	9	5	7	0,7	11
M8 X 1	13	5	11	1	1
M10 X 1	15	5	12	1	11
M12 X 1,5	18	8	12	1	16
M14 X 1,5	20	8	14	1	17
M16 X 1,5	22	8	16	1	17
M18 X 1,5	24	8	18	1	17
M20 X 1,5	26	8	18	1	17
M22 X 1,5	28	8	20	1	17
M24 X 1,5	30	8	20	1,3	18,5
M26 X 1,5	32	8	22	1,3	18,5
M27 X 1,5	33	8	22	1,3	18,5
M27 X 2	33	10	22	1,3	20,5
M33 X 2	40	10	10	1,6	21,5
M39 X 2	47	10	22	1,6	21,5
M42 X 2	50	10	36	36	21,5
M48 X 2	56	10	36	1,6	21,5
G 1/8	15	6	23	1	13
G 1/4	19	8	13	1	17
G 3/8	23	8	17	1	17
G 1/2	27	8	18	1	17
G 3/4	33	8	22	1,3	18,5
G 1	40	10	30	1,6	21,5
G 1 1/4	50	10	36	1,6	21,5
G 1 1/2	56	10	39	1,6	21,5
1/4 UNF	11	6	9	0,7	12
1/2 UNF	18	8	12	1	16
3/4 UNF	26	8	18	1	17

Order example: Plug with metric thread M27x2: Plug 0044 m27x2

Other protective elements



6843841

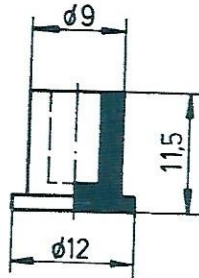

6320618

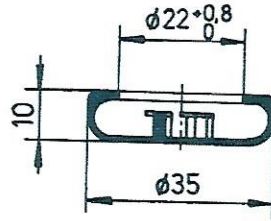

2123487

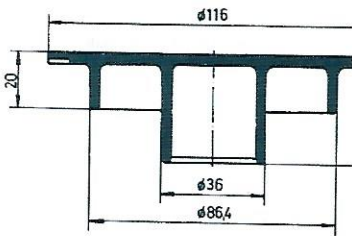

3724150

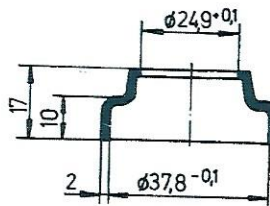

5105978

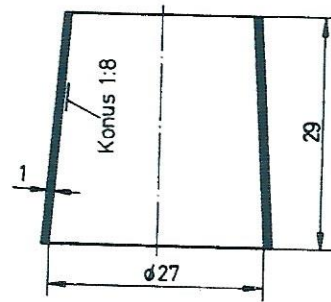

1640135

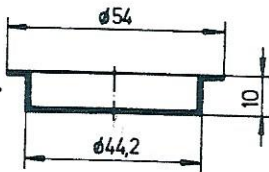

6139976

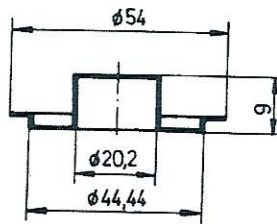

6139646

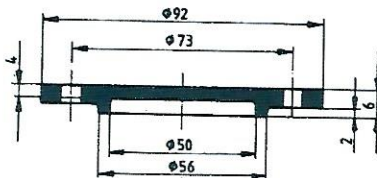

1289693

